

# Passat/Eos Index

<b>Interior</b>	<b>Update</b>	
Cargo Net.....	07/01/07	11
Cargo Partition .....		11
Door Sill Protection .....	07/01/07	39
Floor Mats		
Rubber.....	01/22/08	6-7
Nylon.....	01/22/08	5
Gear Shift Knob.....		8
Gorilla Gear .....		9
Gorilla Grips.....		10
Pedal Caps.....		12
Rear Window Roller Blind .....		13
Trunk Liner.....		8-9
Trunk Organizer .....		10

<b>Exterior</b>		
Body Kits		
Front Valence .....	01/22/08	30
Side Skirt.....		31
Rear Valence .....		33-35
High Definition Body Kits.....	07/01/07	36-37
Cable & Lock Set .....		15
Car Cover .....		15
Chrome Mirror Caps.....		38
Chrome Rear Accent Strip .....		38
Exhaust Tips.....	01/22/08	37
Front Bumper Hole Plugs .....		29
Front End Cover.....		14
Front End & Rear Bumper Protectors .....	01/22/08	35
License Plate Frame .....		See Car Care Section
Lowering Springs.....	01/22/08	42
Lowering Spring Bolt Installation Kit.....		42
Park Distance Sensors .....	01/22/08	41
Splash Guards.....		25
Spoiler (Rear) .....		32-33
Sunroof Air Deflector .....		29
Wind Stop.....	07/01/07	40
Wind Stop Storage Bag .....		40

<b>Wheels</b>	<b>Update</b>	
Alloy Wheels .....	01/22/08	26-27
Lockable Wheel Bolts.....		28
Snow Chains.....		13
Suspension Limiters .....		28
Valve Stem Caps.....		See Car Care Section

<b>Racks</b>		
Bike Holder		
Fork Mount Holder .....	01/22/08	18
Single Bike Holder .....	01/22/08	17
Carrier Bars .....	07/01/07	16
Kayak Rack Attachment.....		23
Luggage Basket.....		20
Luggage Platform.....		19
Roof Box Carrier Attachment.....	01/22/08	43
Snowboard/Ski Attachment.....	01/22/08	21
Snowboard/Ski Attachment Deluxe .....		22
Soft Luggage Carrier.....		19
Surfboard Attachment.....	01/22/08	24

<b>Electronics</b>		
Audio Adapter.....	09/15/07	2
Cassette Holder .....		3
CD Magazine Cartridge.....		2
Glovebox 6 Disc CD Changer.....	01/22/08	2
iPod Adapter.....		4
Telephone Console .....		3

# Glovebox 6-Disc CD Changer

Suggested Retail Labor Time: **100**



Part No.	Description	Application
<b>3C0 057 110</b>	6-Disc CD Changer	Passat Sedan 06 ► 07
or	for vehicles without navigation	Passat Wagon 06 ► 07
<b>3C0 057 110A</b>		

**Note: also required for model year 2008 ► retrofit:**

CD changer cable	<b>1T0 051 592</b>
Mount for CD changer	<b>3C1 857 285 E FKZ</b>
Brake mechanism for CD changer	<b>3C1 858 635</b>
	<b>3C2 858 635</b>
Hinge pins	<b>3C0 857 169</b>

<b>000 051 444M</b>	Adapter Only for vehicles with navigation with aux button	Passat 06 ►
---------------------	---	-------------

- Adapter for connecting an external audio source to the navigation RN S2 DVD and RNS MFD DVD
- Not for vehicles that already have an aux jack installed



## Phone Console



Suggested Retail Labor Time: **50**

Part No.	Description	Application
3C1 051 601 01C	Telephone Console black	Passat Sedan 06 ►
		Passat Wagon 06 ►

- Attaches to the center console of the dash
- The Console is a mount for mobile cell phone, PDA or other personal electronics
- Molded and textured plastic
- Does not include any interface device to connect to electronics

## iPod Adapter



Suggested Retail Labor Time: 150

Part No.	Description	Application	
1K0 051 444	iPod Adapter	Passat Sedan	06 ►
		Passat Wagon	06 ►
		Eos	06 ►

This iPod adapter is intended to be connected to VW Original Radio/Radio Navigation Systems with a CD changer control system, and uses the same wiring connector positions as a CD Changer, Aux Jack, or USB Connector. It will fit both older 1-DIN devices and new generation devices with a Quadlock connection.

### Single input system.

If you fit this iPod Adapter to a standard VW Radio as a Dealer Installed Accessory, or as a Factory installed option, the CD Changer, Aux Jack, or USB connector will be non-functioning. It is not possible to connect and operate two audio devices.

### Multi input system.

Vehicles with Radio Navigation System equipped with CD Changers, Aux Jack or USB Connectors are not impacted by the installation of this iPod adapter.

The integrated radio CD/DVD player and the satellite receiver is NOT affected by the addition of the 1K0 051 444 iPod adapter.

See Accessory Circular **#059-08-06** for answers to Frequently Asked Questions about the use and applications of the iPod Adapter.

## Floor Mats – Passat

**Note:** The oval retention clip is changing to a round retention clip, starting with some 2007 model years. It is important to verify whether the vehicle in question has the oval retention clip, or the larger diameter new round style retention clip, which is a running change. Due to model year production dates, always confirm the retention clip configuration prior to sale.

Part No.	Description	Application
<b>3C1 061 270P ***</b>	Nylon Floor Mats set of 4 front, rear (oval style)	Passat Sedan 06 ▶ 07 Passat Wagon 06 ▶ 07
<b>3C1 061 270PB ***</b>	(new style round)	07.5 ▶
***Color Code: <b>RYJ</b> Euro Black <b>RYL</b> Euro Beige		

Single Components:

<b>3D0 898 501 ***</b>	1 set securing parts, oval clips
<b>3D0 898 501B ***</b>	1 set securing parts, new style round clips
<b>3C0 061 795 9B9</b>	1 set of 4 clips, new style round clips

\*\*\*Color Code: **71N** Black



## Floor Mats – Eos

<b>1Q1 061 270 PA RYJ</b>	Premium Textile Floor Mats set of 4 with logo (logo front only)	Eos	05/06 ▶ 12/06 07.5 ▶
<b>1Q1 061 270 PB RYJ</b>	oval clips		
<b>1Q1 061 275PA RYJ</b>	Premium Textile set of 2 front, with logo, oval clips		
<b>1Q1 061 275PB RYJ</b>	new round style clips		
<b>1Q0 061 276PA RYJ</b>	Premium Textile set of 2 front, with logo, new style round clips rear, no logo, w/o clips		

Color Code: **RYJ**= Euro Black

Single Components:

<b>3D0 898 501 ***</b>	1 set Mat securing parts, oval clips
<b>3D0 898 501B ***</b>	1 set Mat securing parts, new style round clips
<b>3C0 061 795 9B9</b>	1 set of 4 Mat clips, new style round clips

\*\*\*Color Code: **71N** Black

**Note:** The oval retention clip is changing to a round retention clip, starting with the 2007 model year: "P" part numbers fit oval retention clips. "PB" part numbers fit new round style retention clips. Due to model year production dates, always confirm the retention clip configuration.

### Self Threading Carpet Anchors:



**3D0 061 494 A** 1 set of 4 self threading anchors, Phillips head



**3D0 061 796** 1 set of 4 self threading anchors, twist-knob head



## Floor Mats – Passat Monster Mat

**Note:** The oval retention clip is changing to a round retention clip, starting with some 2007 model years. It is important to verify whether the vehicle in question has the oval retention clip, or the larger diameter new round style retention clip, which is a running change. Due to model year production dates, always confirm the retention clip configuration prior to sale.

Part No.	Description	Application
	Floor Mats Deep Groove "Monster" Mats	
<b>3C1 061 550 H 041</b>	Set of four with oval clips	Passat 06 ▶ 12/06
<b>3C1 061 550 HA 041</b>	Set of four with new round style clips	07.5 ▶



- High quality mats, made to take the abuse of an active life style
- Help protect vehicle carpet from snow, sand, mud, rain and slush
- Positive retention clip and a nibbed back help ensure mats stay in place

### Single Components:

<b>3D0 898 501 ***</b>	1 set securing parts, oval clips
<b>3D0 898 501B ***</b>	1 set securing parts, new style round clips
<b>3C0 061 795 9B9</b>	1 set of 4 clips, new style round clips

\*\*\*Color Code: **71N** Black

## Floor Mats – Eos Monster Mat

	Floor Mats Deep Groove "Monster" Mats	
<b>1Q1 061 550 H 041</b>	Set of four with oval clips	Eos 05/06 ▶ 12/06
<b>1Q1 061 550 HA 041</b>	Set of four with new round style clips	07.5 ▶



- High quality mats, made to take the abuse of an active life style
- Help protect vehicle carpet from snow, sand, mud, rain and slush
- Positive retention clip and a nibbed back help ensure mats stay in place

### Single Components:

<b>3D0 898 501 ***</b>	1 set Mat securing parts, oval clips
<b>3D0 898 501B ***</b>	1 set Mat securing parts, new style round clips
<b>3C0 061 795 9B9</b>	1 set of 4 Mat clips, new style round clips

\*\*\*Color Code: **71N** Black

### Self Threading Carpet Anchors:



**3D0 061 494 A** 1 set of 4 self threading anchors, Phillips head



**3D0 061 796** 1 set of 4 self threading anchors, twist-knob head

## Floor Mats – Passat European Style

Part No.	Description	Application
	Rubber Floor Mats set of 2, front or rear	Passat Sedan Wagon
<b>3C1 061 501 ***</b>	front, oval clips	06 ► 12/06
<b>3C0 061 511 ***</b>	rear	06 ► 12/06
<b>3C1 061 501 A ***</b>	front, new round style clips	01/07 ►



- Available as a set of two, front or rear
- Designed to help protect the O.E. carpeting in all kinds of weather
- Waffle pattern, has the Passat logo molded

\*\*\*Color Code:

**041** = Black

**528** = Grey

Single Components:

<b>3D0 898 501 ***</b>	1 set securing parts, oval clips
<b>3D0 898 501B ***</b>	1 set securing parts, new style round clips
<b>3C0 061 795 9B9</b>	1 set of 4 clips, new style round clips

\*\*\*Color Code: **71N** Black

## Floor Mats – Eos European Style

	Rubber Floor Mats set of 2 front	Eos
<b>1Q1 061 501 041</b>	front, oval clips	05/06 ► 12/06
<b>1Q1 061 501A 041</b>	front, new round style clips	01/07 ►



- Designed to help protect the O.E. carpeting in all kinds of weather
- Waffle pattern, has the Eos logo molded

Single Components:

<b>3D0 898 501 ***</b>	1 set Mat securing parts, oval clips
<b>3D0 898 501B ***</b>	1 set Mat securing parts, new style round clips
<b>3C0 061 795 9B9</b>	1 set of 4 Mat clips, new style round clips

\*\*\*Color Code: **71N** Black

Self Threading Carpet Anchors:

 **3D0 061 494 A** 1 set of 4 self threading anchors, Phillips head

 **3D0 061 796** 1 set of 4 self threading anchors, twist-knob head



## Gear Shift Knob



Part No.	Description	Application
<b>1K0 064 285G</b>	Gearshift Knob and Boot 6-Speed	Eos 06 ►
<ul style="list-style-type: none"> <li>• Gearshift knob for 6-speed drive with gaiter, golf ball retro aluminum/leather effect</li> <li>• Simple to exchange through original shift connection</li> <li>• Includes shift knob, boot, and surround</li> </ul>		

## Trunk Liner – Passat



<b>3C5 061 180</b>	Trunk Liner	Passat Sedan	06 ►
<b>3C9 061 180</b>		Passat Wagon	06 ►

- The practical boot protection with Passat logo is washable, non-slip, acid resistant and low-emission.
- The 2 inch (5 cm) raised edge prevents liquids running out onto the vehicle floor.
- Color: anthracite



## Trunk Liner – Eos



Part No.	Description	Application
<b>1Q0 061 180</b>	Trunk Liner	Eos 06 ▶ Not for 3.2L
<ul style="list-style-type: none"> <li>• Provides luggage compartment protection with EOS logo</li> <li>• Washable, non-slip, acid resistant and low-emission.</li> <li>• The edge stands approx. 2 inches (5 cm) high all round, preventing liquids from running out</li> </ul>		
<b>Special features</b> Not for 3.2l V6 vehicles Not for vehicles with an additional battery in the luggage compartment (V6 engine)		

## Gorilla Gear – Passat



<b>3C5 061 166H 469</b>	Gorilla Gear Trunk Liner	Passat
<b>3C9 061 166H 469</b>	Sedan	06 ▶
	Wagon	06 ▶

An ingenious trunk tray. Fits snugly in your trunk area, yet is easy to remove. Heavy-duty rubber backing makes the bottom rugged and durable. Stain-resistant looped Polywear makes the top easy to hose off. Comes standard with a set of four Gorilla-Grips.

## Gorilla Grips



Part No.	Description	Application
<b>ZVW 380 301</b>	Gorilla-Grips set of 4	All

- Designed to work with the Gorilla-Gear Cargo Mat.
- Strong Velcro® backers fasten tightly to the looped polywear surface
- Perfect for grouping, dividing and protecting goods and cargo



## Trunk Organizer



<b>ZVW 386 001</b>	Trunk Organizer	All
--------------------	-----------------	-----

- Spring loaded set-up
- Durable ABS plastic, anti-bacterial materials
- Restraining straps and d-rings prevent sliding
- Integrated partitions organize cargo
- Molded grab handles ensure easy handling
- Folds flat for convenient storage
- Dimensions
  - Closed: 14.5" x 25" x 2"
  - Opened: 14.5" x 25" x 7"

## Cargo Net



Part No.	Description	Application
<b>3C5 065 110</b>	Luggage Net	Passat Sedan 06 ►
<b>3C9 065 110</b>	Luggage Net	Passat Wagon 06 ►

- Luggage net also folds into a hammock style carrier
- Elasticized nylon net utilizes 4 securing hooks to attach to lockdown clamps in vehicle trunk
- Securely holds bulky items in place
- Color: anthracite

## Cargo Partition



<b>3C9 017 221</b>	Cargo Partition (Metal)	Passat Wagon 06 ►
--------------------	-------------------------	-------------------

- Partition grille tubular frame, black steel mesh, with airbag
- Separates the luggage area from the passenger area between the rear seat back and roof liner.
- No additional drilling is required.
- Can also be used on vehicles with head air bag

## Pedal Caps



Suggested Retail Labor Time: **75**

Part No.	Description	Application	Transmission
<b>1K1 064 200</b>	SPORT Set - Metal, incl. accelerator, brake & clutch pedal caps	Passat 06 ► Eos* 07 ►	<b>M</b>
<b>1K1 064 205</b>	SPORT Set - Metal, incl. accelerator and brake pedal caps		<b>A</b>
<b>1K1 864 551 TKH</b>	SPORT aluminum footrest*		<b>B</b>

\* Except vehicles that already come equipped with Sport pedal packages.

Transmission: **A = Automatic**  
**M = Manual**  
**B = Both**

- Installation instructions included

See Accessory Circular #**047-08-06-UCF** for additional application information

<b>1K1 721 503Q</b>	R-LINE Pedal Cap, Accelerator	Passat 06 ► Eos* 07 ►	<b>M</b> <b>M</b>
<b>1K0 721 131A 4J4</b>	R-LINE Clutch Pedal Cap		
<b>1K1 721 601A 4J4</b>	R-LINE Brake Pedal Cap		
<b>1K1 723 131 4J4</b>	R-LINE Brake Pedal Cap	Passat 06 ► Eos* 07 ►	<b>A</b> <b>A</b>



\* Except vehicles that already come equipped with Sport pedal packages. Installation instructions included

Transmission: **A = Automatic**  
**M = Manual**  
**B = Both**

## Roller Blind, rear window



Part No.	Description	Application
<b>3C0 064 360</b>	Roller Blind for rear window	Passat 06 ▶ Sedan

- -Protects from strong sunlight and stops the interior warming up

## Snow Chains\*

Close Out



Part No.	Description	Application
<b>000 091 386D</b>	Snow chains (205/55R16 - 16"x6.5" ET 42 rim) or (205/50R17 - 17"x6" ET 45 rim)	Passat 06 ▶
<b>000 091 386D</b>	Snow chains (205/55R16 - 16"x6.5" ET 42 rim) or (205/50R17 - 17"x6" ET 45 rim)	Eos 07 ▶

- Special RUD snow chain. Easy and quick fitting to stationary vehicle possible. Special fine-linked chain. The spring steel shackle chain is pre-adjusted and always ready for fitting. TÜV tested. With fitting instructions 2 per set.

\*Check state, county, province and local laws prior to operating your vehicle with snow chains. Consult your Owner's Manual for information about the safe use of snow chains on your vehicle.

## Front End Cover



Suggested Retail Labor Time: **50**

Part No.	Description	Application	
<b>ZVW 193 118</b>	Front End Cover	Passat	06 ►
<b>ZVW 193 025</b>	Front End Cover 2 piece set complete	Eos	06 ►

**Not applicable for vehicles with front valance or headlight washer system.**

Designed for the protection of those finished front end surfaces most susceptible to damage from flying road debris. For user convenience, engine compartment opens without detachment of cover. Constructed for fitting to the vehicle with combinations of padded hi-flex metal tabs, coated hooks and elastics especially suitable for DIY installation, without drilling. Outline is provided for access opening front license plate. Vehicle logo-type embroidered in silver thread.

Made from premium grade materials to ensure optimum useful service life:

- High gloss vinyl of 14 oz./sq. yd. weight, UV and mildew resistant, with backing of 8 oz./sq. yd. polyester foss
- High tensile strength polyester binding used on all seams and edges
- All fasteners (tabs, hooks, elastics) enveloped and surface protected with non-corrosive covered/sheathing

**⚠ Note:** Requires regular maintenance. Read installation and care instructions carefully.

See Accessory Circular #**022-08-06 UCF** for additional information



## Car Cover



Part No.	Description	Application
<b>3C5 061 205 H</b>	Car Cover – "Stormshield" grey, with silk screened logo complete with storage bag	Passat Sedan 06 ▶
<b>1Q0 061 205 H</b>	Car Cover – "Stormshield" grey, with silk screened logo complete with storage bag	Eos 06 ▶

- High degree of moisture repellence and breathability
- Long life ultraviolet (UV) resistance
- Resistance to dust, acid rain, tree sap and other airborne particulate matter
- Light weight for easy installation and removal
- Custom mirror pockets
- Plastipane rear license plate window
- Double stitch seams for strength and long life
- Elasticized hems for fit and stability and tie-down grommets

### Important Notes

Do not use a cover on a vehicle which has been repainted within the last 6 months.

If your vehicle has delicate paint, such as lacquer, exercise caution. Some repainted vehicles are not painted properly and may blister.

If there is excessive wind and your cover is flapping against your vehicle, remove the cover.

Do not cover a vehicle while it is being towed.

If a haze appears on your windows after covering your vehicle, it is caused by airborne pollution. Wash your cover.

### Troubleshooting

The main problems people encounter with their cover is residual thread or lint left on the vehicle after covering it.

This is just excess material left over from the manufacturing process, and will stop after the first two weeks of use.

See Accessory Circular #027-08-06 UCF for additional information

### ZVW 400 110 Cover Cable and Lock set

The nonscratching plastic coated cable slides through the special sewn-in grommets, and the lock keeps the cover secured to the vehicle.





## Roof Carrier System - Carrier Bars



Part No.	Description	Application
<b>3C0 071 126</b>	Carrier Bars, Basic lockable set of 2 cross bars complete with mounting instructions and hardware	Passat Sedan 06 ►
<b>3C9 071 151 666</b>	Carrier Bars, Basic	Passat Wagon 06 ►

Two plastic-coated aerodynamic aluminum cross bars. Anodized aluminum section. Plastic supporting feet, cover caps and covers. Galvanized plastic coated steel plate. The lockable unit has built-in cylinder locks mounted into the full length end bracket covers.

Bar dimensions: 1350 x 180 x 270 mm / weight: 7.0 kg

**The maximum permissible roof load is 165 lbs/75 kg, evenly distributed. Consult your Owner's Manual for weight specifications.**

Single Components:

No.	Description	Qty.	No.	Description	Qty.
1	Allen key	1	15	Tensioning clamp, RL	1
2	Tubular section, front	1	16	Tensioning clamp, RR	1
3	Tubular section, rear	1	17	Bump rubber	4
4	Sliding block	4	18	Coded tensioning bolt	4
5	Supporting foot cover	4	19	Washer, steel	4
6	Screw cover	8	20	Sleeve, steel	4
7	Screw M6x16	8	21	Cover cap	4
8	Supporting foot, FL	1	22	Cover plate	4
9	Supporting foot, FR	1	23	Screw 2.5x5	4
10	Supporting foot, RL	1	24	Moulded cap	4
11	Supporting foot, RR	1	25	Cover section	2
12	Screw 4x8	8	26	Torque wrench	1
13	Tensioning clamp, FL	1	27	Fitting instructions	1
14	Tensioning clamp, FR	1			

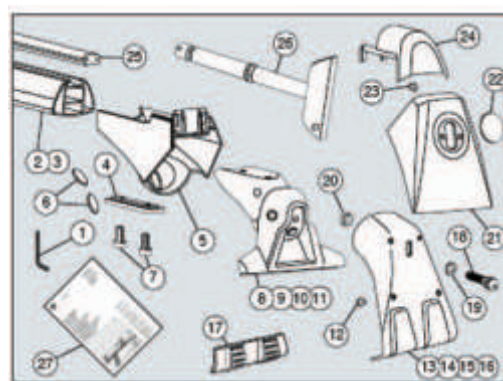

# Bike Carrier System



Part No.	Description	Application
<b>6Q0 071 128 A</b>	Bicycle Holder Attachment for 1 bicycle. Complete with mounting hardware and instructions	Fits All with "T Slot" Basic Carrier Bars

Bike Holder dimensions: 1580 x 180 x 290 mm / weight: 4.6 kg

- For transport of Touring, Mountain and Racing Bikes in an upright position.
- Built-in lock and rugged design prevents damage to valuable bicycles.
- Up to three (3) bicycles can be mounted using a staggered formation.
- **NOTE:** Some of the largest downhill race tire sizes may not fit.
- Maximum frame width=80mm, maximum tire width=56mm, maximum frame height=90mm

	Code Keys	Fits All MontBlanc
<b>000 092 795 AA</b>	1 Set of Code Keys	<b>Code 21</b>
<b>000 092 795 AB</b>	1 Set of Code Keys	<b>Code 23</b>
<b>000 092 795 AC</b>	1 Set of Code Keys	<b>Code 25</b>
<b>000 092 795 AD</b>	1 Set of Code Keys	<b>Code 27</b>
<b>000 092 795 AE</b>	1 Set of Code Keys	<b>Code 29</b>

- Original replacement keys for Montblanc roof carrier and attachment parts

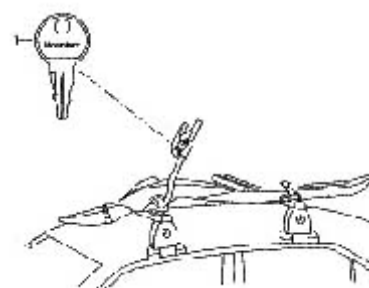

## Single components

### Bicycle Holder 6Q0 071 128 A

Key#	Description	Qty.	Key#	Description	Qty.
1	.....Frame holder.....	1	14	.....Securing sleeve .....	1
2	.....Cap .....	1	15	.....Tlocking device .....	1
3	.....Tube clamp.....	1	16	.....Wheel mount .....	1
4	.....Screws (for plastic).....	2	17	.....Fitting instructions .....	1
5	.....Lever for frame holder.....	1	18	.....T-screw, short .....	1
6	.....Lock .....	1	19	.....Screw, short.....	1
7	.....Securing tube.....	1	20	.....Securing bracket, rear .....	1
8	.....Front lever .....	2	21	.....Rear lever .....	1
9	.....Pin .....	3	22	.....Rear securing plate .....	1
10	.....Securing bracket, front.....	2	23*	.....Rear wheel holder.....	1
11	.....T-screw, long .....	2	24	.....Screw.....	1
12	.....Screw, long .....	2	25	.....Nut .....	1
13*	.....Front wheel holder .....	1			

\*Spare parts can be ordered under part # **6Q0 071 740**

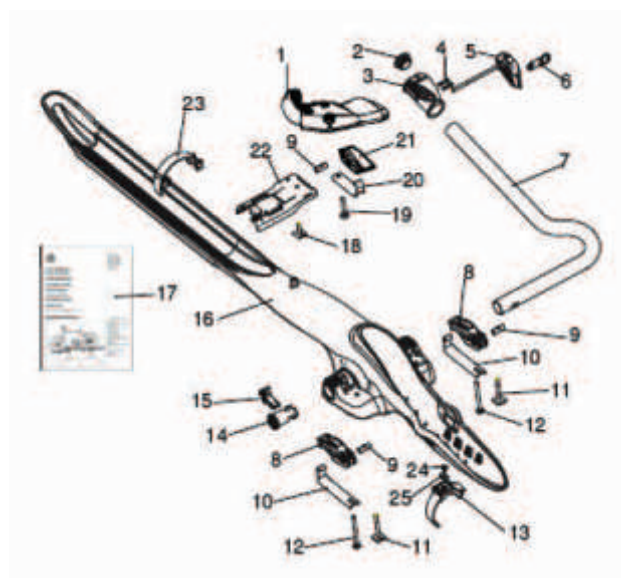

# Bike Carrier System

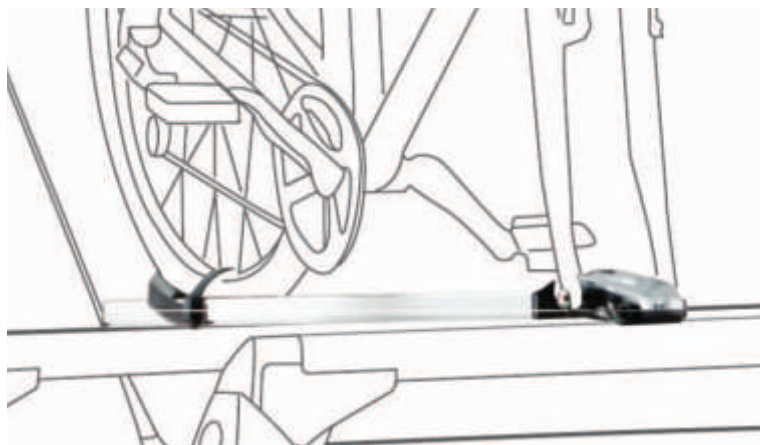

Part No.	Description	Application
<b>7M0 071 128 C</b>	<p>Accepts bikes with disc brakes</p> <p>Bicycle holder for fork attachment</p> <p>Bike Holder dimensions: 1320 x 85 x 130 mm / weight: 2.8 kg</p> <p>Fits up to 3 racks (2 forward, 1 rear facing)</p>	<p>Fits All</p> <p>with Basic Carrier Bars</p>

**NOTE:** The holding strap may not fit some of the largest downhill race tire sizes.

Single Components:

Description	Qty.	Part No.
Lock . . . . .	1 . . . . .	<b>1F0 071 267A</b>
Loslager, Unterlegplatte . . . . .	1ea. . . . .	<b>1F0 071 737D</b>
Spannband aus Radhalt. . . . .	1 . . . . .	<b>1F0 071 740</b>
Endkappen . . . . .	2 . . . . .	<b>1F0 071 745</b>
Radhalterung . . . . .	1 . . . . .	<b>1F0 071 746</b>

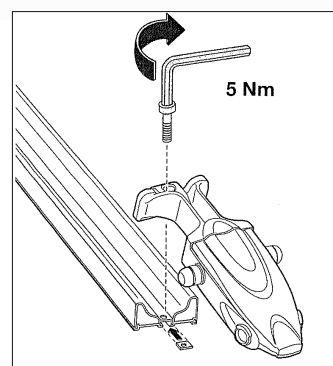
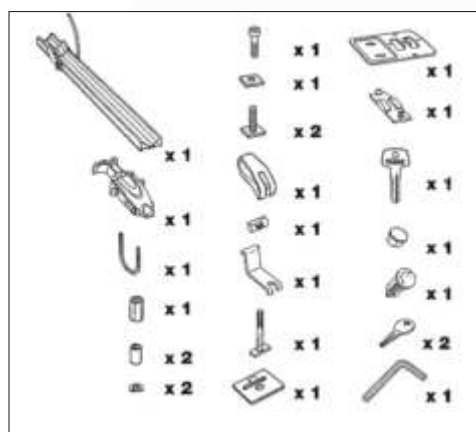
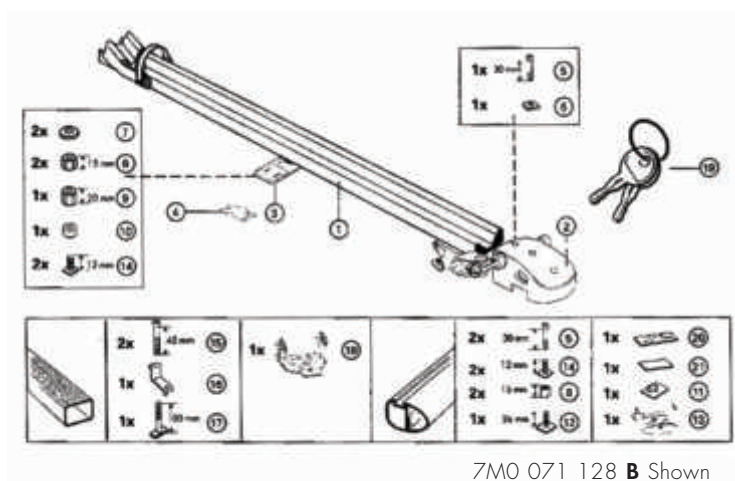

**7M0 071 128 C**  
("C" version front fork mount)

## Luggage Platform



Part No.	Description	Application
<b>00H 071 130</b>	Luggage Platform complete with mounting hardware and instructions	Fits All with Basic Carrier Bars

Basket dimensions: 1140 x 120 x 950 mm / weight: 10.0 kg

- Provides shallow tray
- Pre-assembled
- Aluminum construction

## Soft Luggage Carrier



<b>ZVW 193 800</b>	Soft Luggage Carrier and Luggage Basket <b>191 071 130 F</b> or Luggage Platform <b>00H 071 130</b>	All
--------------------	---	-----

- Heavy duty
- Weather proof
- Black polyester construction
- Accommodates 7.7 cubic feet of cargo
- 6 tie-down straps with quick release buckles
- Covered zipper

# Classic Luggage Basket



Part No.	Description	Application
<b>191 071 130 F</b>	Classic Luggage Basket complete with mounting hardware and instructions	Fits All with Basic Carrier Bars

- Galvanized steel, black plastic coated
- Transverse end tubular bars, front and rear, are adjustable:  
Closed: up position forms a luggage basket  
Open: down position forms a loading platform

Luggage Basket dimensions: 1120 x 70 x 200 mm / weight: 6.8 kg

## Single components - Luggage Basket 191 071 130 F

Key No.	Description	Qty.
1	Side Section	2
2	Retaining bar	1
3	Supporting bar	1
7	Capstan head screw	4
	Mounting Kit	191 071 736 D
4	Self tapping screws	12
5	Plastic washer	12
6	Hex head bolt	8
10	Threaded shackle	4
11	Hex head nut	4
12	T-shaped keyway insert	4
13	Shackle	4
14	U-shaped shackle	4
	Set of Screw Connectors	191 071 743 C
	6 Hex head bolt	8
	9 Hex head nut	4
	8 Slotted bolt	4

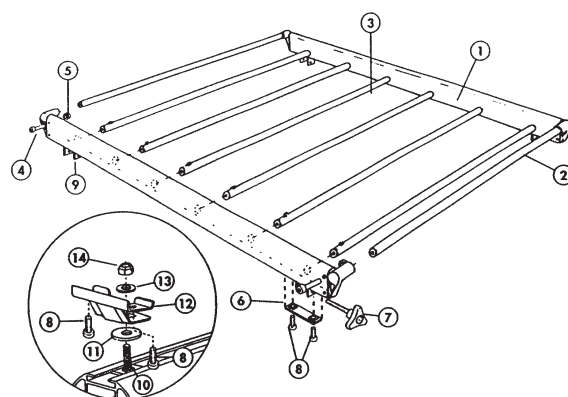

## Snowboard/Ski Attachment

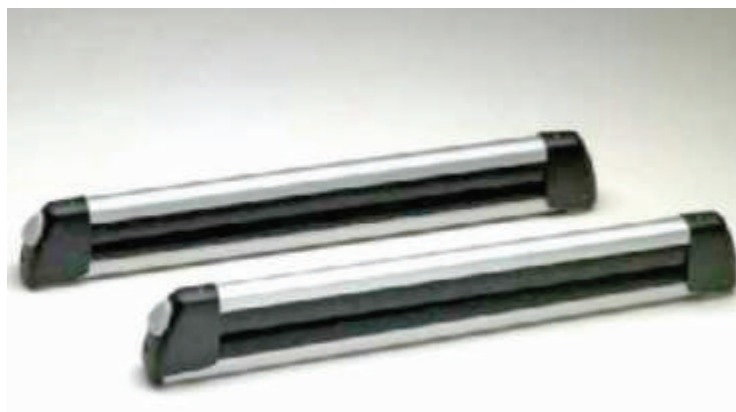

Part No.	Description	Application
<b>3B0 071 129 UA</b>	Snowboard/Ski attachment – lockable complete with mounting hardware	Fits All with Basic flat Carrier Bars

- Carries four pairs of skis or two snowboards
- Perfect blend of styling, quality and rugged design
- Installs quickly on base carrier and features an oversized push button locking hood that allows for easy opening and closing with gloves on
- Wide semi-rigid rubber profile design provides a snug secure fit for snowboard or skis

Ski Rack dimensions: 790 x 130 x 130 mm / weight: 3.6 kg

### Single components – Snowboard/Ski attachment **3B0 071 129 UA**

#### Key

No.	Description	Qty.
1 . . . .	Ski/Snowboard carrier . . .	2
2 . . . .	Wing bolt, M6x35 . . . . .	4
3 . . . .	Spacer block . . . . .	4
4 . . . .	Keyway, M6 . . . . .	4
5 . . . .	Retaining clip . . . . .	4
6 . . . .	Wing knob, M6x20 . . . . .	2
7 . . . .	Key . . . . .	2

Attachment Kit  
**3B0 071 737A**

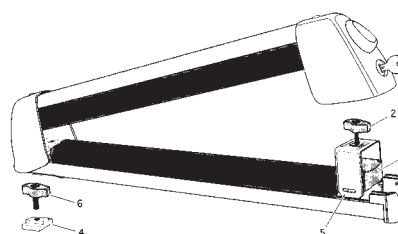



## Snowboard/Ski Attachment – Deluxe



Part No.	Description	Application
<b>1T0 071 129</b>	Deluxe Snowboard/Ski attachment – lockable complete with mounting hardware	Fits All with Basic Carrier Bars

- For maximum of 6 pairs of skis or 4 snowboards
- Easy to load and unload with a practical pull-out action
- Lockable
- Made from anodized aluminum section

Ski Rack dimensions: 835 x 130 x 130 mm / weight: 4.8 kg

### Single components – Snowboard/Ski attachment **1T0 071 129**

#### Key

No.	Description	Qty.
1	Ski/Snowboard holder	2
2	Key	2
3	Allen nut M6	4
4	Spring washer	4
5	Allen key SW5	1
6	Plastic washer	4
7	T-bolt M6x16	4
8	Fitting instructions	1

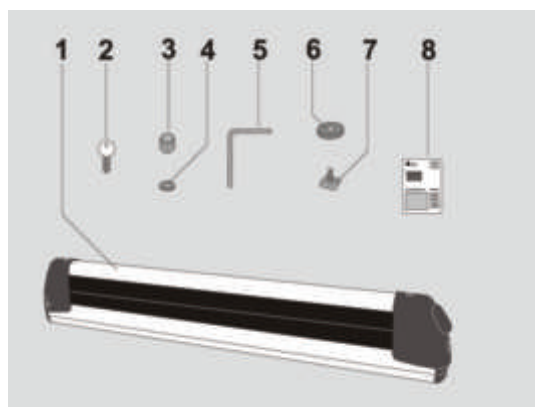



# Kayak Holder



Part No.	Description	Application
<b>1K0 071 127</b>	Kayak Rack Attachment	Fits All with Basic Carrier Bars



- 4 rubber coated holders which adapt to the shape of the kayak
- Tie straps included
- Holds one kayak

Rack dimensions: 480 x 190 x 120 mm / weight: 1.75 kg

Load maximum: 55 lb/25 kg. Consult your Owner's Manual for weight specifications and important safety information.

Maximum kayak length: 8 ft. 2 in./2.4 m

Single components – Kayak attachment – **1K0 071 127**

## Key

Item	Description	Qty
1	Kayak holder	4
2	Slide block M6 x 22	4
3	Washer M6	4
4	Hex nut M6	4
	1.5mm high	
5	Tensioning strap	2
	approx. 4.000 mm	
6	Fitting instructions	1

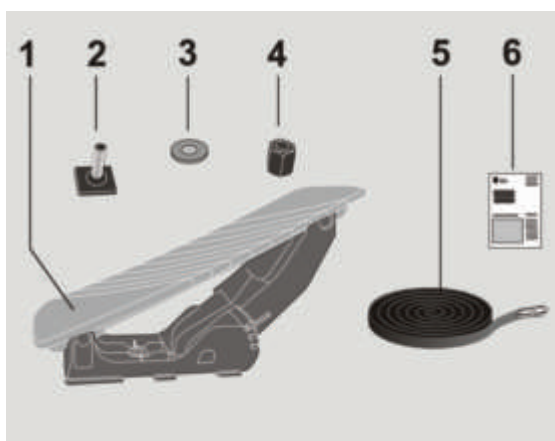

# Surfboard Holder



Part No.	Description	Application
445 071 127	Surfboard Holder Attachment	Fits All with Basic Carrier Bars

- 4 plastic holders which adapt to the shape of the surfboard
- For transporting of 1 or 2 surfboards with masts

Holder dimensions: 310 x 100 x 140 mm / weight: 1.84 kg

Single components – Surfboard attachment – 445 071 127

Key No.	Description	Part No.
2	Tensioning Rubber	445 071 737B
4	Hardware Kit	445 071 737C

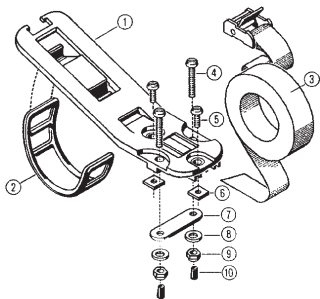

Replaced by 000 071 120H

000 071 120H	Surfboard Holder Attachment	Fits All Carriers with T-slot profile
--------------	-----------------------------	---------------------------------------

The surfboard holder transports your surfboard safely to the destination. The surfboard and two masts are held in place by robust fastening fixtures. The rubber-coated surfboard supports and special rubber protection for metal clips on the retaining straps ensure the highest possible protection for your surfboard during transportation.

- Surfboard nose must point downwards in the direction of travel
  - Suitable for 1 surfboard and 2 masts only
- Includes:
- 2 Surfboard supports
  - 2 Retaining straps (275 cm each)
  - 2 Rubber caps
  - 4 Mast holders with retaining straps



## Splash Guards – Passat

Suggested Retail Labor Time: **40**



Part No.	Description	Application	
<b>3C0 075 111</b>	Splash Guards, front set of 2 with mounting hardware matte black	Passat Sedan	06 ►
		Wagon	06 ►
<b>3C0 075 101</b> or <b>3C0 075 101A</b>	Splash Guards, rear set of 2 with mounting hardware matte black	Sedan	06 ►
		Wagon	06 ►

Single Components:

**3C0 075 711 Front** Fastening kit

**3C0 075 701 Rear** Fastening kit

- Designed for a flush contour fit to help ensure body protection
- Temperature resistant material tested under extreme driving conditions

## Splash Guards – Eos



<b>1Q0 075 111</b>	Splash Guards, front set of 2 with mounting hardware matte black	Eos	06 ►
<b>1Q0 075 101</b>	Splash Guards, rear set of 2 with mounting hardware matte black	Eos	06 ►

Single Components:

**1Q0 075 711 Front** Fastening kit

**1Q0 075 701 Rear** Fastening kit

See Accessory Circular **#032-08-06-UCF** For Replacement Splash Guard Mounting Hardware Kits.

# Alloy Wheels

A note about our wheel and summer performance tire assemblies: Our high performance wheel and tire assemblies as well as some of the tires required for our larger diameter accessory alloy wheels are designed for optimum performance and handling in warm climates. They are not suitable for cold, snowy, or icy weather conditions. If the car is driven under those circumstances, the vehicle should be equipped with all-season or winter tires which offer better traction under those conditions. We suggest you use the recommended winter or all season tire specified for the vehicle or its equivalent. These high-performance tires also have a lower aspect ratio that aids performance and handling; however, in order to avoid tire, rim, or vehicle damage, it is important that the inflation pressure is regularly checked and maintained at recommended levels. Please also remember in making your selection that, while these tires deliver responsive handling, they may ride less comfortably and make more noise than other choices. Finally, these tires may wear more quickly than other choices. For further information on all these topics, please consult the vehicles owner's manual or call your facing Parts Distribution Center.

Part No.	Description	Application	
<b>3C0 071 496 666</b>	7 spoke light alloy wheel 6.5 x 16 ET42 Brilliant/Silver Metallic	Passat Sedan 4 cyl. 06 ▶ Wagon 4 cyl. 06 ▶ Eos 06 ▶	205/55 R16
<ul style="list-style-type: none"> <li>• Attractively designed rim</li> <li>• The alloy wheel is supplied 1 per box complete with VW Hub Cap</li> <li>• Uses standard wheel bolts and rubber valve</li> </ul>			
Single Components			
<b>3B7 601 171</b>	Center Hub Cap – VW		



Tango

<b>3C0 071 497 666</b>	10-spoke Light Alloy Wheel 7.5 x 17 ET 47 Brilliant/Silver Metallic	Passat Sedan 06 ▶ Wagon 06 ▶ Eos 06 ▶	235/45 R17
<ul style="list-style-type: none"> <li>• Attractively designed rim</li> <li>• The alloy wheel is supplied 1 per box complete with VW Hub Cap</li> <li>• Uses standard wheel bolts and rubber valve</li> </ul>			
Single Components			
<b>3B7 601 171</b>	Center Hub Cap – VW		



Azuro





<b>3C0 071 497 V7U</b>	10-spoke Light Alloy Wheel 7.5J x 17 ET 47 Internal titanium/external mirror finish	Passat Sedan 05/03 ▶ Wagon 06 ▶ Eos 06 ▶	235/45 R17
<ul style="list-style-type: none"> <li>• Attractively designed rim</li> <li>• The alloy wheel is supplied 1 per box complete with VW Hub Cap</li> <li>• Uses standard wheel bolts and rubber valve</li> </ul>			
Single Components			
<b>3B7 601 171</b>	Center Hub Cap – VW		



Azuro - Diamond Black

Legend: 6.5 J x 16  
 16 = diameter in inches  
 J = flange version  
 6.5 = rim width in inches

# Alloy Wheels

Part No.	Description	Application	
<b>3C9 071 497 666</b>	10-spoke Light Alloy Wheel 7.5J x 17 ET 47 Brilliant Metallic	Passat	235/45 R17
		Sedan	06 ▶
		Wagon	06 ▶
		Eos	06 ▶
<ul style="list-style-type: none"><li>• Attractively designed rim</li><li>• The alloy wheel is supplied 1 per box complete with VW Hub Cap</li><li>• Uses standard wheel bolts and rubber valve</li></ul>			
Locking wheel bolt set <b>000 071 591 A</b>			
Single Components			
<b>3B7 601 171</b>	Center Hub Cap – VW		
			
<b>Arigos</b>			
<b>3C5 071 497 666</b>	10-spoke Light Alloy Wheel 7.5J x 17 ET 47 Sterling Silver Metallic	Passat	235/45 R17
		Sedan	06 ▶
		Wagon	06 ▶
		Eos	06 ▶
<ul style="list-style-type: none"><li>• Attractively designed rim</li><li>• The alloy wheel is supplied 1 per box complete with VW Hub Cap</li><li>• Uses standard wheel bolts and rubber valve</li></ul>			
Locking wheel bolt set <b>000 071 591 A</b>			
Single Components			
<b>3B7 601 171</b>	Center Hub Cap – VW		
			
<b>Akiros</b>			
<b>3C0 071 498A V7U</b> or <b>3C0 071 498 V7U</b>	Multi-spoke Light Alloy Wheel 8J x 18 ET44 Complete with VW Logo Hub Cap Diamond Black Metallic	Passat	235/40R18-95
		Sedan	06 ▶
		Wagon	06 ▶
		Eos	06 ▶
<ul style="list-style-type: none"><li>• Attractively designed rim</li><li>• The alloy wheel is supplied 1 per box complete with VW Hub Cap</li><li>• Uses standard wheel bolts and rubber valve</li></ul>			
Locking wheel bolt set <b>000 071 591 A</b>			
<b>Suspension Limiters Required (000 071 501 or 000 071 501A)</b>			
Must be used in conjunction with suspension limiters for vehicles originally not equipped with sport suspension. Rear alignment should also be inspected.			
Single Components			
<b>3B7 601 171</b>	Center Hub Cap – VW		
			
<b>Velos - Diamond Black</b>			
<b>3C0 071 498A 666</b> or <b>3C0 071 498 666</b>	Multi-spoke Light Alloy Wheel 8J x 18 ET44 Complete with VW Logo Hub Cap Sterling Silver Metallic	Passat	235/40R18-95
		Sedan	06 ▶
		Wagon	06 ▶
		Eos	06 ▶
<ul style="list-style-type: none"><li>• Attractively designed rim</li><li>• The alloy wheel is supplied 1 per box complete with VW Hub Cap</li><li>• Uses standard wheel bolts and rubber valve</li></ul>			
Locking wheel bolt set <b>000 071 591 A</b>			
<b>Suspension Limiters Required (000 071 501 or 000 071 501A)</b>			
Must be used in conjunction with suspension limiters for vehicles originally not equipped with sport suspension. Rear alignment should also be inspected.			
Single Components			
<b>3B7 601 171</b>	Center Hub Cap – VW		
			
<b>Velos - Silver</b>			

## Suspension Limiters – 18" wheels



Part No.	Description	Application
000 071 501	Suspension Limiters <b>Mandatory</b> for 18" Wheels (only)	Passat
or		Sedan 06 ►
000 071 501A		Wagon 06 ►
000 071 501A		Eos 06 ►

- This suspension limiter set is a mandatory stipulation when fitting 18 inch diameter wheels on vehicles not equipped with sport suspension from the factory.

## Lockable Wheel Bolts



000 071 597	Lockable Wheel Bolts set of 4, 2-Piece complete with matched key	Passat
		Sedan 06 ►
		Wagon 06 ►
		Eos 06 ►

Weight, shape and length correspond to the standard wheel bolts. Standard wheel bolts can still be used on all wheels. Not for use in conjunction with standard two-piece wheel bolts with loose spherical collar.



## Sunroof Air Deflector



Suggested Retail Labor Time: **50**

Part No.	Description	Application
<b>3C0 072 192 U</b>	Air Deflector – Sunroof kit complete with mounting hardware, gasket and instructions	Passat Sedan       06 ▶ Wagon      06 ▶

The WeatherTech® Sunroof Wind Deflector gives you an excellent reduction of in-cabin wind noise and air turbulence! It is crafted in Germany from the finest 4mm thick, tinted cast acrylic. Our sunroof deflector fits the sunroof opening precisely, and is held securely in place with the MagiClip vehicle specific fastening system. To protect your vehicle's finish, the unique AirCushion gasket seals the edge of the deflector. WeatherTech Sunroof Wind Deflector's sleek and sophisticated look is a great addition to any vehicle.

- One-piece molded tinted acrylic Plexiglas
- One bracket per side clamps into the sunroof opening
- Installation without drilling

## Front Bumper Hole Plugs

<b>ZVW 355 999</b>	Chrome or black plugs	Passat Eos	All
--------------------	-----------------------	---------------	-----

- For vehicles drilled for front license plates installation that subsequently won't require a front plate mount





## Body Kits



Part No.	Description	Application
<b>3C0 071 609 GRU</b>	Front Valance kit complete 1 piece (primed)	Passat Sedan 06 ► Wagon 06 ►

- Installation and painting instructions included
- Painting of body kit to body color required
- Ideal for custom paint or collision repair

**NOTE:** The adhesive needed to complete the assembly of these components is not included in the kit. Contact your local body shop supply firm to obtain the proper adhesive such as "DOW Betaseal 17042 Advanced Cure Urethane" or equivalent.

### Dealer Drop Ship Program

Drop Ship Number Roush	Description	Color Code
<b>3C0 071 609 RS C9X</b> . . . . .	Deep Black . . . . .	2T2T
<b>3C0 071 609 RS C8Z</b> . . . . .	Mocha Brown . . . . .	3Q3Q
<b>3C0 071 609 RS B6S</b> . . . . .	Granite Green . . . . .	4W4W
<b>3C0 071 609 RS B5M</b> . . . . .	Arctic Blue Silver . . . . .	7J7J
<b>3C0 071 609 RS A7W</b> . . . . .	Reflex Silver . . . . .	8E8E
<b>3C0 071 609 RS B9A</b> . . . . .	Candy White . . . . .	B4B4
<b>3C0 071 609 RS D1W</b> . . . . .	Wheat Beige . . . . .	D1D1
<b>3C0 071 609 RS D5Q</b> . . . . .	Shadow Blue . . . . .	P6P6
<b>3C0 071 609 RS C5F</b> . . . . .	Blue Graphite . . . . .	W9W9
<b>3C0 071 609 RS A7T</b> . . . . .	United Gray . . . . .	X6X6

## Body Kits



Part No.	Description	Application
<b>3C0 071 685 GRU</b>	Side Skirts kit complete 2 pieces (primed)	Passat Sedan 06 ► Wagon 06 ►

- Installation and painting instructions included
- Painting of body kit to body color required
- Ideal for custom paint or collision repair

**NOTE:** The adhesive needed to complete the assembly of these components is not included in the kit. Contact your local body shop supply firm to obtain the proper adhesive such as "DOW Betaseal 17042 Advanced Cure Urethane" or equivalent.

### Dealer Drop Ship Program

Drop Ship Number Roush	Description	Color Code
<b>3C0 071 685 RS C8Z</b> . . . . .	Mocha Brown . . . . .	3Q3Q
<b>3C0 071 685 RS B6S</b> . . . . .	Granite Green . . . . .	4W4W
<b>3C0 071 685 RS B5M</b> . . . . .	Arctic Blue Silver . . . . .	7J7J
<b>3C0 071 685 RS A7W</b> . . . . .	Reflex Silver . . . . .	8E8E
<b>3C0 071 685 RS B9A</b> . . . . .	Candy White . . . . .	B4B4
<b>3C0 071 685 RS D1W</b> . . . . .	Wheat Beige . . . . .	D1D1
<b>3C0 071 685 RS D5Q</b> . . . . .	Shadow Blue . . . . .	P6P6
<b>3C0 071 685 RS C5F</b> . . . . .	Blue Graphite . . . . .	W9W9
<b>3C0 071 685 RS A7T</b> . . . . .	United Gray . . . . .	X6X6

## Body Kits



Part No.	Description	Application
<b>3C0 071 640 GRU</b>	Rear Spoiler primed, without 3rd brake light	Passat Sedan 06 ►

- Impact resistant, integral polyurethane foam spoiler increases vehicle's rear down force
- Recommend paint to body color

**NOTE:** The adhesive needed to complete the assembly of these components is not included in the kit. Contact your local body shop supply firm to obtain the proper adhesive such as "DOW Betaseal 17042 Advanced Cure Urethane" or equivalent.

### Dealer Drop Ship Program

Drop Ship Number Roush	Description	Color Code
<b>3C0 071 640 RS C9X</b> . . . . .	Deep Black . . . . .	2T2T
<b>3C0 071 640 RS C8Z</b> . . . . .	Mocha Brown . . . . .	3Q3Q
<b>3C0 071 640 RS B6S</b> . . . . .	Granite Green . . . . .	4W4W
<b>3C0 071 640 RS B5M</b> . . . . .	Arctic Blue Silver . . . . .	7J7J
<b>3C0 071 640 RS A7W</b> . . . . .	Reflex Silver . . . . .	8E8E
<b>3C0 071 640 RS B9A</b> . . . . .	Candy White . . . . .	B4B4
<b>3C0 071 640 RS D1W</b> . . . . .	Wheat Beige . . . . .	D1D1
<b>3C0 071 640 RS D5Q</b> . . . . .	Shadow Blue . . . . .	P6P6
<b>3C0 071 640 RS C5F</b> . . . . .	Blue Graphite . . . . .	W9W9
<b>3C0 071 640 RS A7T</b> . . . . .	United Gray . . . . .	X6X6

## Body Kits



Part No.	Description	Application
<b>3C9 071 640 GRU</b>	Rear Spoiler primed, without 3rd brake light	Passat Wagon 06 ►

- Impact resistant, integral polyurethane foam spoiler increases vehicle's rear down force
- Recommend paint to body color

**NOTE:** The adhesive needed to complete the assembly of these components is not included in the kit. Contact your local body shop supply firm to obtain the proper adhesive such as "DOW Betaseal 17042 Advanced Cure Urethane" or equivalent.

<b>3C0 071 610 UA GRU</b>	Rear valance - Exhaust exit on left I4/V6	Passat Sedan 06 ►
---------------------------	--	----------------------

- Recommend paint to body color

### Special features

Not in conjunction with towing hitch

### Dealer Drop Ship Program

Drop Ship Number Roush	Description	Color Code
<b>3C0 071 610 RS C9X</b> . . . . .	Deep Black . . . . .	2T2T
<b>3C0 071 610 RS C8Z</b> . . . . .	Mocha Brown . . . . .	3Q3Q
<b>3C0 071 610 RS B6S</b> . . . . .	Granite Green . . . . .	4W4W
<b>3C0 071 610 RS B5M</b> . . . . .	Arctic Blue Silver . . . . .	7J7J
<b>3C0 071 610 RS A7W</b> . . . . .	Reflex Silver . . . . .	8E8E
<b>3C0 071 610 RS B9A</b> . . . . .	Candy White . . . . .	B4B4
<b>3C0 071 610 RS D1W</b> . . . . .	Wheat Beige . . . . .	D1D1
<b>3C0 071 610 RS D5Q</b> . . . . .	Shadow Blue . . . . .	P6P6
<b>3C0 071 610 RS C5F</b> . . . . .	Blue Graphite . . . . .	W9W9
<b>3C0 071 610 RS A7T</b> . . . . .	United Gray . . . . .	X6X6



## Body Kits



Part No.	Description	Application
<b>3C9 071 610A GRU</b>	Rear valance Exhaust exit on left I4/V6	Passat Wagon 06 ►

- Recommend paint to body color

### Special features

Not in conjunction with towing hitch



<b>3C0 071 610 UB GRU</b>	Rear valance Exhaust exit on left & right (4motion V6)	Passat Sedan 06 ►
---------------------------	--	----------------------

- Recommend paint to body color

### Special features

Not in conjunction with towing hitch

# Body Kits



Part No.	Description	Application
3C9 071 610B GRU	Rear valance Exhaust exit on left & right (4motion V6)	Passat Wagon 06 ►

- Recommend paint to body color

**Special features**  
Not in conjunction with towing hitch

## Front End and Rear Bumper Protectors



3C5 061 197	Clear Vinyl Protector rear bumper	Passat Sedan 06 ►
3C9 061 197		Wagon 06 ►
1Q0 061 197		Eos 06 ►
3C5 061 195U	Stainless Steel Protector rear bumper	Passat Sedan 06 ►
3C9 061 195		Wagon 06 ►
3C0 061 191U	Clear Vinyl Protector front end, without park distance control	Passat Sedan 06 ► Wagon 06 ►

- Scratch-resistant, protects the paint and chrome surfaces



## Body Kits – Passat High Definition

**Note:** For Drop Ship details, ordering information and specific Passat High Definition body kit components and High Definition Kits, visit the **"Parts on Command"** for colors and availability.



Part No.	Description	Application
<b>3C5 071 609 GRU</b>	Front Valance/Bumper (primer) 2.0L, 3.6L	Passat Sedan Wagon
<b>3C5 071 685 GRU</b>	Side Skirts	

- Recommend paint to body color
- Available pre-painted - check for availability

<b>3C5 071 610U GRU</b>	Rear Valance, left exhaust exit (primer) FWD only (2.0L, 3.6L)	Passat Sedan
<b>3C5 071 610UA GRU</b>	Rear Valance, left and right exhaust exit (primer) 4motion V6 only	

- Recommend paint to body color
- Available pre-painted - check for availability

Note: Dual Exhaust Tips **3C0 071 912** or **3C0 071 913** must be ordered in conjunction with the left or the left and right exhaust exit valances.



### Dealer Drop Ship Program - Front Bumper, Side Skirts, Rear Valance

Front Bumper*	Side Skirts	Rear Valance	
		FWD	4Motion
3C5071609RS***	3C5071685RS***	3C5071610RS***	3C5071614RS***

*** Color Code	Description
C9X	Deep Black
A7W	Reflex Silver
B9A	Candy White
D5Q	Shadow Blue
C5F	Blue Graphite
C8Z	Mocha Brown
Y3D	Toronado Red – Comes with Black accent color instead of United Gray

\* High Def Front Bumpers are shipped without the side grille sets. Grille sets must be ordered separately based on vehicle fog light requirement.



## Body Kits – Passat High Definition

**Note:** For Drop Ship details, ordering information and specific Passat High Definition body kit components and High Definition Kits, visit the **"Parts on Command"** for colors and availability.



Part No.	Description	Application
<b>3C5 071 640 GRU</b>	Rear lip spoiler, primer	Passat Sedan 06 ►

- Recommend paint to body color
- Available pre-painted - check for availability

### Dealer Drop Ship Program - Rear Lip Spoiler

Rear Lip Spoiler	***Color Code	Description
3C5071640RS***	C9X	Deep Black
	A7W	Reflex Silver
	B9A	Candy White
	D5Q	Shadow Blue
	C5F	Blue Graphite
	C8Z	Mocha Brown

## Exhaust Tips

<b>3C0 071 912</b>	Dual Exhaust Tips Exit left (Front Wheel Drive)	Passat Sedan 06 ►
--------------------	--	----------------------

<b>3C0 071 913</b>	Exit left and right – 4 Motion
--------------------	--------------------------------

- Highly polished
- No weld installation
- Requires cutting



<b>3C0 071 910 U</b>	Exhaust Tips	Passat Sedan Wagon 06 ►
----------------------	--------------	-------------------------------

- Stainless steel dual exhaust tips, corrosion resistant
- Easy slip-over design
- Highly polished



## Chrome Rear Accent Strip



Suggested Retail Labor Time: **25**

Part No.	Description	Application
<b>3C5 071 360</b>	Chrome rear accent strip	Passat Sedan 06 ►
<b>1Q0 071 360</b>		Eos 06 ►

Add a distinctive touch to the look of your vehicle with a rear chrome look accent

- These chrome look accents offer a scratch and impact resistant surface
- High gloss with strong three-dimensional appearance
- Self-adhesive, easy installation
- One (1) set, consists of one (1) rear chrome look accent, fitting instructions, and cleaning cloth

## Chrome Mirror Caps



Suggested Retail Labor Time: **50**

<b>1KM 072 530 1ZL</b>	Chrome mirror caps	Passat 06 ►
		Eos 06 ►

## Door Sill Protection

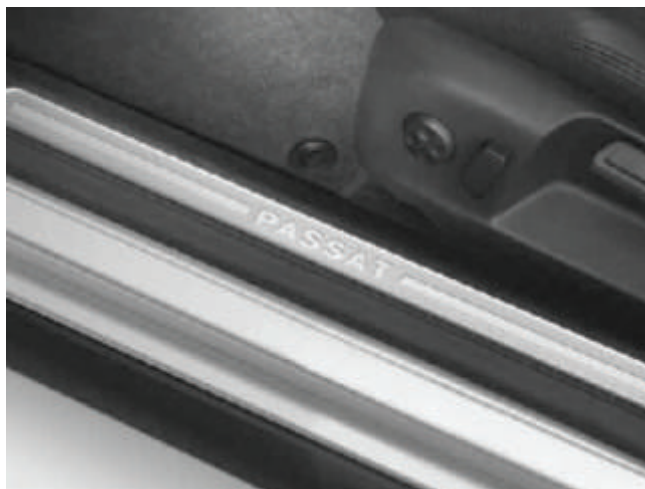

Part No.	Description	Application
<b>3C0 071 305</b>	Door Sill Protection 4 per set	Passat Sedan Wagon

06 ►

06 ►

- For all four doorways, with background laser engraved Passat lettering on the front scuff plates
- Protects the sill area from scratches and damage
- Easy installation with stick-on adhesive



<b>1Q0 071 310</b>	Door Sill Protection Black w/Silver Stripe, 2 per set	Eos	06 ►
--------------------	--	-----	------

- Protects the sill area from scratches and damage
- Easy installation with stick-on adhesive

# Windstop

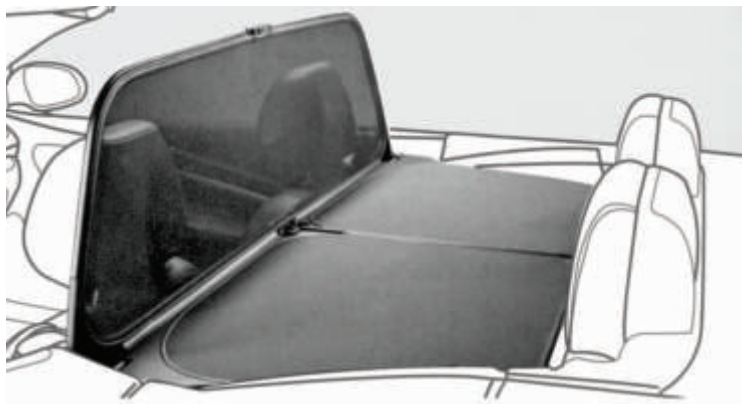

Part No.	Description	Application
1Q0 862 951D 03C	Windstop complete with attaching hardware, installation instructions	Eos 06 ► for vehicles not factory equipped

Relaxed open-top driving—and not only at 20 mph!

A touch of elegance in a classic design allowing you to race with the wind.

The Windstop is a precision-fitting unit designed to minimize annoying and unpleasant air turbulence, which reverberates around the windshield. Convertible fans, driving with the top down, can enjoy the unobstructed view in every direction.

The Windstop is made of black vinyl and mesh screen merging style, elegance and function while providing durability and practicability. The design and engineering of the unit allows for easy installation without any additional or permanent mounting, special tools or drilling, and does not have to be removed to put the top up. The unit can be removed and secured in the storage bag.

See Technical Bulletin **05-16-06, #2011897/1** for information about Locking Pins Breakage on the Wind Deflector.

Single Components:

1Y0 862 957	Windscreen Pivot (left)	Eos 06 ►
1Y0 862 958	Windscreen Pivot (right)	
1Y0 862 655	Coupling Piece (left)	
1Y0 862 656	Coupling Piece (right)	
1Y0 862 685	Catch (left)	
1Y0 862 686	Catch (right)	

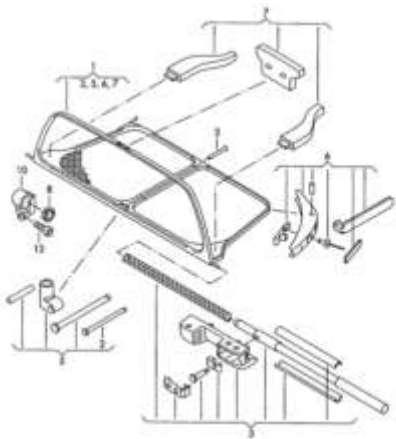

# Windstop Storage Bag



1Q0 862 965A K84	Storage bag for vehicles not factory equipped	Eos 06 ►
------------------	---	----------

## Park Distance Control



Suggested Retail Labor Time: **250**

Part No.	Description	Application
<b>3C0 054 630</b>	Backup warning 4 sensors, acoustic warning function	Passat
or		Sedan 06 ►
<b>000 054 630A</b>		Wagon 06 ►

The park distance control, with 4 sensors and acoustic warning function provides additional safety when parking. This park distance control is easy to install and effectively helps avoid unsightly damage to the bumpers when reversing. A short sound emitted when reverse gear is engaged indicates that the system is active. The closer the vehicle comes to the obstacle, the more frequently the signal is emitted. The microprocessor-controlled park distance control function is automatically activated when reverse gear is selected and checks for errors using the self diagnostic function. Sensors can be painted so they blend unobtrusively into the overall vehicle image. Electrical connection to the reversing light is easy requiring no routing of cables to the front of the vehicle.

The park distance control function has an intelligent set-up function. For example, rigid towing hitches are not incorrectly detected as obstacles.

- Complete with control unit, four sensors, sound source, connection cables, fitting material, fitting and operating instructions.

# Sport Springs



Part No.	Description	Application	Engine	Transmission
<b>3C0 071 678</b>	Sport Suspension Spring kit complete	Passat Sedan	06 ▶ 2.0L	Manual
<b>3C0 071 679</b>			06 ▶ 2.0L	Auto
			06 ▶	

Not for vehicles equipped with factory lowered sport suspension

- Lowers the standard center of gravity of the vehicle without sacrificing comfort
- High dynamic load capacity
- Sporty look
- High quality corrosion protection

## All-in-One Bolt Installation Kit



<b>ZVW 269 007</b>	All-in-One Bolt Installation Kit with standard suspension only	Passat 06 ▶
--------------------	---	-------------

When installing Sport Spring Packages, some suspension fasteners are “Single Use”. This means that once removed from the vehicle they must be replaced with a new VW OEM fastener.



## Roof Box Carrier Attachment



Part No.	Description	Application
<b>000 071 200G UKR</b>	Roof Box Carrier Attachment Size: 84" L x 34.4" W x 16.9" H Weight: 44lbs.	Fits Passat Carriers with T-slot profile

Constructed using high impact, UV resistant ABS plastic with ridged base channeling to make a durable yet very lightweight box. The eye-catching design and styling features a lowered front and rear, with the base and the spoiler on the lid designed to enhance aerodynamic properties.

The one-key locking system features a user-friendly, padded key and readable decal. The locking system has a built-in safety feature which means the key can only be removed when box is fully closed. Three lock down points on each side of box - one central lock for each side.

- 18 sq. feet of storage space, enough room for snowboards, skis (modern shorter shape-skis only), watersport equipment, luggage and camping gear
- Dual-side opening allows you to access gear from either side of your vehicle
- Struts help lift the lid open and shut with ease
- Aerodynamic shape reduces wind drag and noise
- Quick Grip hardware mounts to crossbars quickly and easily
- One Key System (locks included) with two matching locks and two oversized padded keys
- Finished in Metallic Silver or Metallic Black (687B)
- Limited Lifetime Warranty provided by the manufacturer (Thule)